



Feature Description Document

IXM WEB Architecture & Network Requirements

Purpose

This document outlines the IXM WEB Architecture & Network Requirement prerequisites for IXM WEB Installation.

Applies to

TITAN	TFACE	TOUCH 2	SENSE 2	MERGE 2	MYCRO
All Devices	All Devices	All Devices	All Devices	All Devices	All Devices

Description

IXM WEB is a web-based .net software that can be installed on a server and be accessed from any device that has internet access or access to the specific server. This helps put the user and the company in charge of when and from where they can access the software

The System Architecture is as follows:



The WEB Cloud Architecture is as follows:

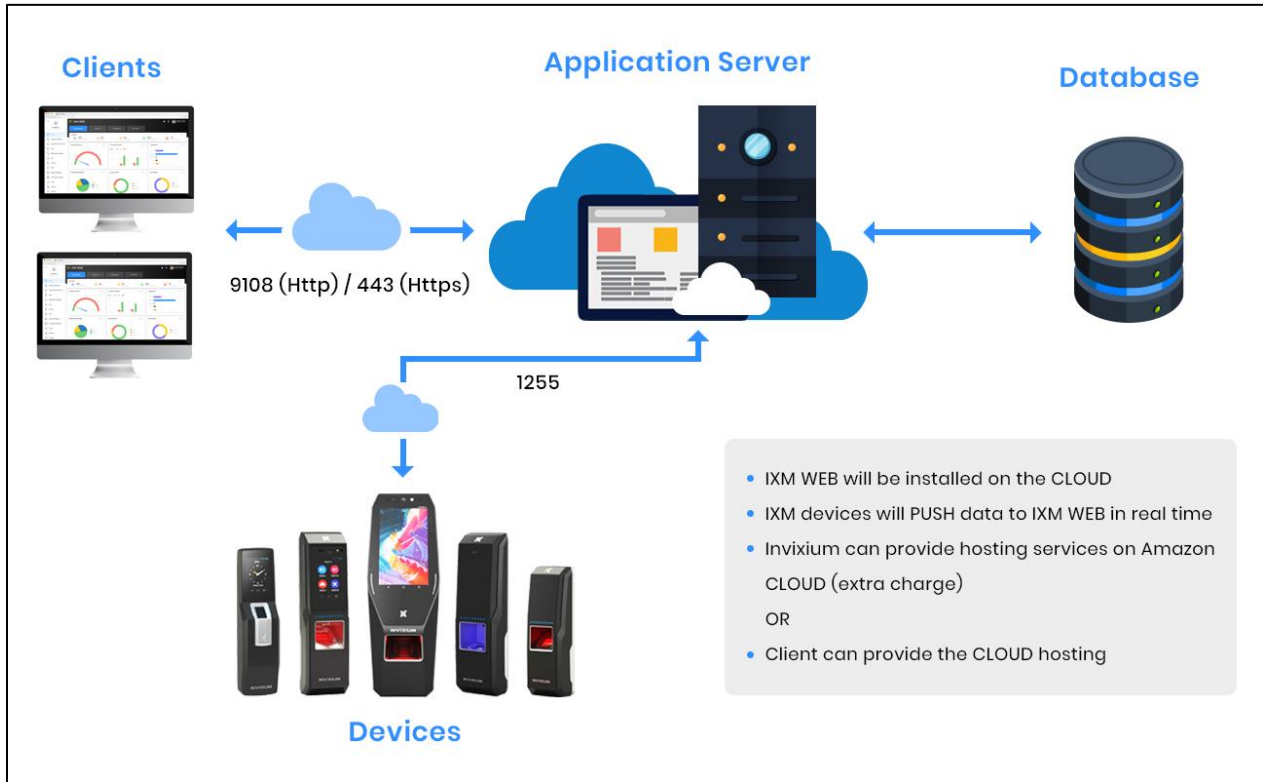



Network Requirement

1. Inbound Http Port 9108 or Https 443 port

- Http Port 9108 is essential for establishing a connection between the web application process and the IIS Web Server. It is also used for communication between Device and server – for Push notification and Heartbeat.
- IXM WEB is installed by default binding to incoming port 9108. This can be configured during the installation of IXM WEB or after installation from Microsoft IIS management tools.
- This is the network port that the system service listens on for incoming network traffic.

2. TCP 1433

IXM WEB uses SQL Server as the database platform. Port 1433 is the default port for SQL Server. This port is also the official Internet Assigned Number Authority (IANA) socket number for SQL Server. Client systems use TCP 1433 to connect to the database engine. You can reconfigure SQL Server to listen on a different port.

3. Port 9734

Communications between devices and IXM WEB across the network are initiated and take place over port 9734, which may require reconfiguring some personal or corporate firewalls that block packets to discover the device and establish a connection.

4. Inbound Port 1255

As IXM WEB is a cloud-ready application it can be deployed on a publicly hosted server. To manage the devices over a public network, which includes device registration, configuration and maintenance port 1255 is required access from both networks.



Supported Operating Systems

IXM WEB is applicable for the following 32-bit and 64-bit operating systems

(NOTE: Windows Home Premium, Professional or Enterprise versions only):

- Windows 8.1
- Windows 10 (Build 1709 or higher) Professional Version
- Windows Server 2012 R2
- Windows Server 2012
- Windows Server 2016 Standard

Microsoft .NET Framework: .Net Framework 4.7.2.0

Database Engine: - MS SQL Server 2014 Express Edition (Default Installation), MS SQL Server 2014, MS SQL Server 2014 R2

IIS Internet Information Services: - Microsoft® Internet Information Services version 7.5 or higher

Installer: Windows® Installer (Installs Automatically) version 4.5 or higher



Support

For more information relating to this Feature Description document, please contact us at support@invixium.com

Disclaimers and Restrictions

This document and the information described throughout are provided in its present condition and are delivered without written, expressed, or implied commitments by Invixium Inc. and are subject to change without notice. The information and technical data herein are strictly prohibited for the intention of reverse engineering and shall not be disclosed to parties for procurement or manufacturing.

This document may contain unintentional typos or inaccuracies.

TRADEMARKS

The trademarks specified throughout the document are registered trademarks of Invixium Access Inc. All third-party trademarks referenced herein are recognized to be trademarks of their respective holders or manufacturers.

Copyright © 2022, INVIXIUM. All rights reserved.